

THIS IS A PRINT OF THE VIEW OF THE REGISTER OBTAINED FROM HM LAND REGISTRY SHOWING THE ENTRIES SUBSISTING IN THE REGISTER ON 11 FEB 2013 AT 15:07:55. BUT PLEASE NOTE THAT THIS REGISTER VIEW IS NOT ADMISSIBLE IN A COURT IN THE SAME WAY AS AN OFFICIAL COPY WITHIN THE MEANING OF S.67 LAND REGISTRATION ACT 2002. UNLIKE AN OFFICIAL COPY, IT MAY NOT ENTITLE A PERSON TO BE INDEMNIFIED BY THE REGISTRAR IF HE SUFFERS A LOSS BY REASON OF A MISTAKE CONTAINED WITHIN IT. THE ENTRIES SHOWN DO NOT TAKE ACCOUNT OF ANY APPLICATIONS PENDING IN THE REGISTRY. FOR SEARCH PURPOSES THE ABOVE DATE SHOULD BE USED AS THE SEARCH FROM DATE.

THIS TITLE IS DEALT WITH BY LAND REGISTRY, FYLDE OFFICE.

TITLE NUMBER: LAN90912

There is no application or official search pending against this title.

A: Property Register

This register describes the land and estate comprised in the title.

LANCASHIRE : PRESTON

- 1 The Freehold land shown edged with red on the plan of the above title filed at the Registry and being land on the east side of The Square, Whittingham.
- 2 (14.09.2000) The land has the benefit of the following rights granted by the Deed of Grant dated 30 April 1991 made between (1) The Lancashire County Council (the Council) and (2) The Secretary Of State For Health (the Secretary Of State):-

"The rights granted by clause 4.1 are the right for the Secretary of State its successors in title the owners and occupiers for the time being of the Second Property to lay construct use inspect maintain repair replace or remove a surface water outfall drain in and over a strip of land shown coloured blue on the plan and amounting in total to some one hundred and twenty square yards or thereabouts"

NOTE: The Second Property referred to includes the land in this title.

B: Proprietorship Register

This register specifies the class of title and identifies the owner. It contains any entries that affect the right of disposal.

Title absolute

- 1 (15.07.2009) PROPRIETOR: THE PARISH COUNCIL OF WHITTINGHAM of 53 Cumeragh Lane, Whittingham, Preston PR3 2AN.

End of register

Land Registry Current title plan

Title number LAN90912
Ordnance Survey map reference SD5636SE
Scale 1:1250 enlarged from 1:2500
Administrative area Lancashire : Preston



© Crown Copyright. Produced by Land Registry. Reproduction in whole or in part is prohibited without the prior written permission of Ordnance Survey. Licence Number 100026316.

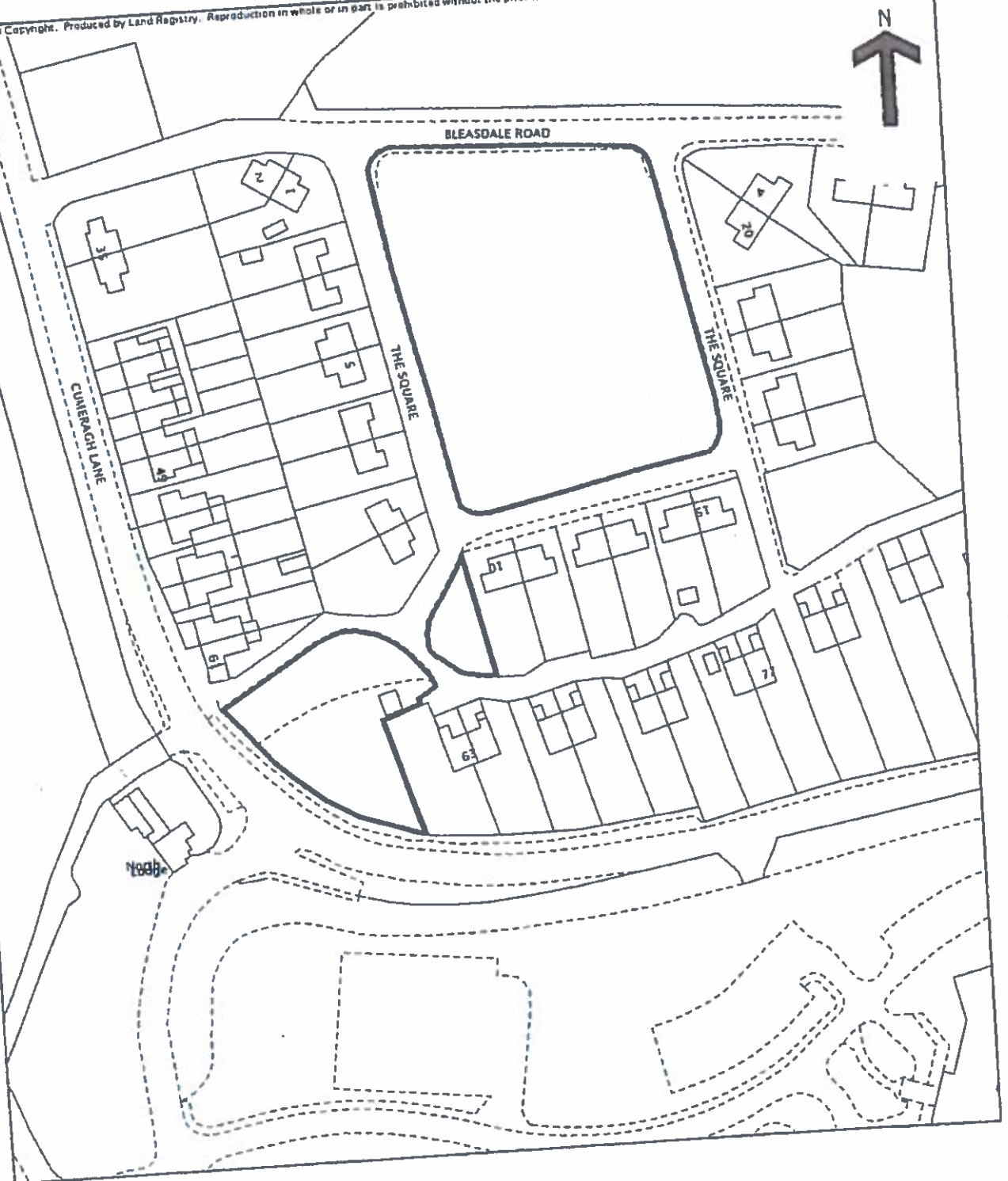

This is a print of the view of the title plan obtained from Land Registry showing the state of the title plan on 11 February 2013 at 15:08:57. This title plan shows the general position, not the exact line, of the boundaries. It may be subject to distortions in scale. Measurements scaled from this plan may not match measurements between the same points on the ground. See Land Registry Public Guide 19 - Title plans and boundaries.

This title is dealt with by Land Registry, Fylde Office.